

OTRC-N

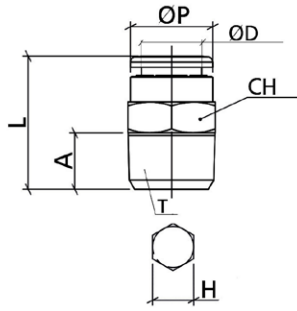

Male connector internal hexagonal NPT thread nickel plated

CODE	ØD	T	ØP	A	L	CH	H
OTRC532N01	5/32"	N1/8"	0,393	0,334	0,748	7/16"	1/8"
OTRC532N02	5/32"	N1/4"	0,393	0,413	0,787	9/16"	1/8"
OTRC1-4N01	1/4"	N1/8"	0,511	0,334	0,885	1/2"	3/16"
OTRC1-4N02	1/4"	N1/4"	0,511	0,413	0,885	9/16"	3/16"
OTRC516N01	5/16"	N1/8"	0,551	0,334	1,062	9/16"	3/16"
OTRC516N02	5/16"	N1/4"	0,551	0,413	1,003	9/16"	1/4"
OTRC516N03	5/16"	N3/8"	0,551	0,452	0,925	11/16"	1/4"
OTRC38N01	3/8"	N1/8"	0,629	0,334	1,122	11/16"	3/16"
OTRC38N02	3/8"	N1/4"	0,629	0,413	1,181	11/16"	1/4"
OTRC38N03	3/8"	N3/8"	0,629	0,452	1,003	11/16"	5/16"
OTRC38N04	3/8"	N1/2"	0,629	0,570	1,043	7/8"	5/16"
OTRC1-2N02	1/2"	N1/4"	0,748	0,413	1,318	7/8"	1/4"
OTRC1-2N03	1/2"	N3/8"	0,748	0,452	1,338	7/8"	3/8"
OTRC1-2N04	1/2"	N1/2"	0,748	0,570	1,181	7/8"	3/8"

OTROC-N

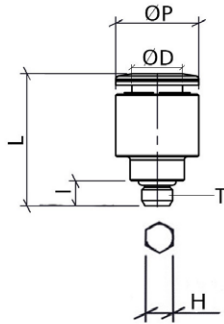

Male connector internal hexagon UNF thread nickel plated

CODE	ØD	T	ØP	I	L	H
OTROC532UF1032	5/32"	UNF 10-32	0,393	0,157	0,748	3/32"
OTROC1-4UF1032	1/4"	UNF 10-32	0,511	0,157	0,846	3/32"

OTRMM

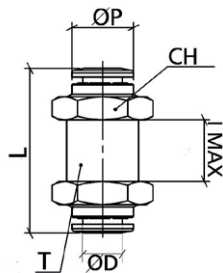

Bulkhead connector nickel plated

CODE	ØD	T	ØP	L	I MAX	CH
OTRMM04	4	M12X1	10	34	15	16
OTRMM06	6	M14X1	12	32	12	17
OTRMM08	8	M16X1	14	36,5	16	19
OTRMM10	10	M20X1	16	43	19	24
OTRMM12	12	M22X1,5	19	44	20	25

